

# GREENHEAD

SERIES

2CESTNÉ REPRODUKTOROVÉ SYSTÉMY S AKTIVNÍMI SUBWOOFERY

## CONTENTS

1	Introduction	3
2	Installation	3
3	Description	4
3.1	Speakers controls & connections	4
3.2	Subwoofer controls & connections	6
3.3	Power supply	8
4	Troubleshooting	9
5	Technical specifications	10
6	Notes	32

### PACKAGE CONTENT

- 1x Fullrange Active Speaker - Mod. 10-12-15
- 1x Active Subwoofer - Mod. 15S-18S
- 1x Mains cable with VDE plug
- 1x User manual - Section 1
- 1x User manual - Section 2

The warnings in this manual must be observed together with the "User manual - Section 2".

## 1 | INTRODUCTION

Thank you for choosing a **A.N.T - Advanced Native Technologies** - product! In **GREENHEAD** series of speaker we have put our passion and our technological background gained over the years, to offer products that meet your needs, maintaining the quality over time.

All models in this series provide an extended frequency response with a clean, undistorted sound even at very high volumes. Specifically designed for an immediate and user-friendly application, meeting the needs of those who are looking for an audio system delivering excellent performances, high connection versatility as well as the best value in its category.

Please, dedicate some minutes to read this instruction manual in order to quickly achieve the best performances from this product.

For safety precautions, warranty and disposal, please refer to attached Section 2.

For further information about all **A.N.T** products catalog, please visit our website: [www.ant-sound.com](http://www.ant-sound.com)

## 2 | INSTALLATION

**GREENHEAD** models are provided of:

- A** | Integrated side and upper handles
- B** | Lower hole for speaker Pole mounting
- C** | Upper hole for speakers support pole insert

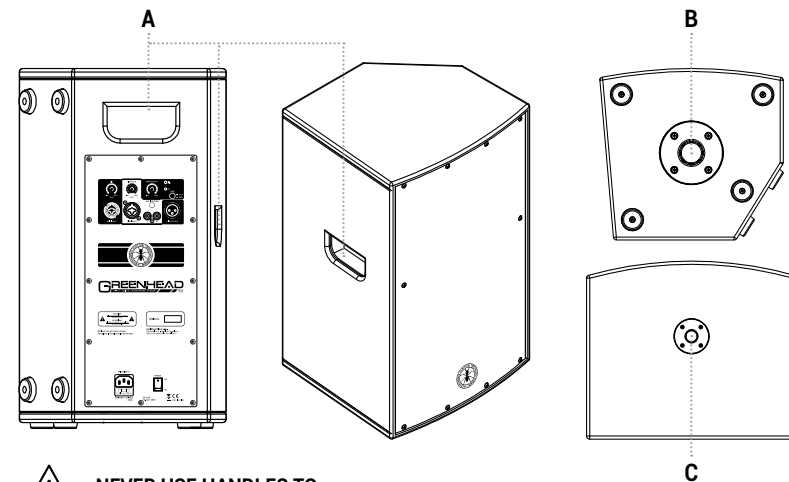

**NEVER USE HANDLES TO SUSPEND THE SPEAKER!**

## 3 | DESCRIPTION

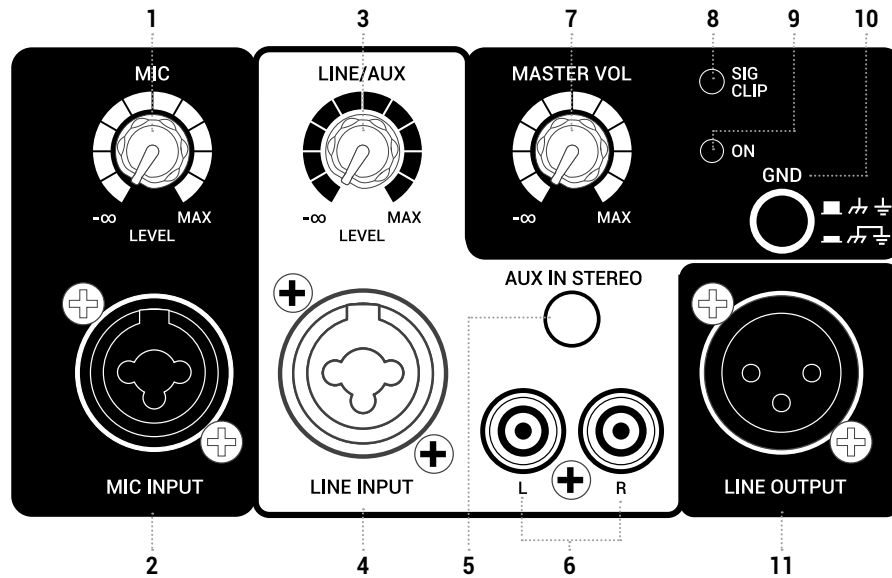

### 3.1 | SPEAKERS CONTROLS & CONNECTIONS

#### 1 MIC LEVEL

This knob adjusts the microphone channel level. Turn the knob clockwise to increase volume, or counterclockwise to decrease it.

#### 2 MIC INPUT

Balanced Combo - XLR/6.35 mm. jack - microphone input  
You may also use an unbalanced microphone cable.

#### 3 LINE/AUX LEVEL

This knob adjusts the Line/Aux channel level. Turn the knob clockwise to increase volume, or counterclockwise to decrease it.

#### 4 LINE INPUT

Balanced combo - XLR/6.35 mm. jack - line input.  
You may also use an unbalanced cable.

#### 5 AUX IN STEREO

Unbalanced 3.5mm stereo input plug for any external device (smartphone, tablet, pc, ecc).

#### 6 L/R

Unbalanced inputs with two RCA plugs for external devices like CD, DVD player and MIXER.

#### 7 MASTER VOL

Speaker master control. Turn the knob clockwise to increase volume, or counterclockwise to decrease it.

#### 8 SIG/CLIP

Led lit green: input signal present.

Led lit red: Indicates the activation of the internal limiter circuit preventing amplifier distortion and protecting the speakers against overloads. In this case, reduce the MASTER level and that of the sound source.

#### 9 ON

This LED is lit when the unit is plugged to mains, and the power switch is ON.

#### 10 GND

Press this switch to reduce or eliminate the noise of the electric ground when connecting signal lines between multiple devices. It is very effective in eliminating ground loops, but the actual result depends also on other connected devices.

#### 11 LINE OUTPUT

This XLR-M output provides a balanced line-level signal with the mix of inputs, before the MASTER control.  
It is useful for connection to an audio system or to another active speaker.

## 3.2 | SUBWOOFER CONTROLS & CONNECTIONS

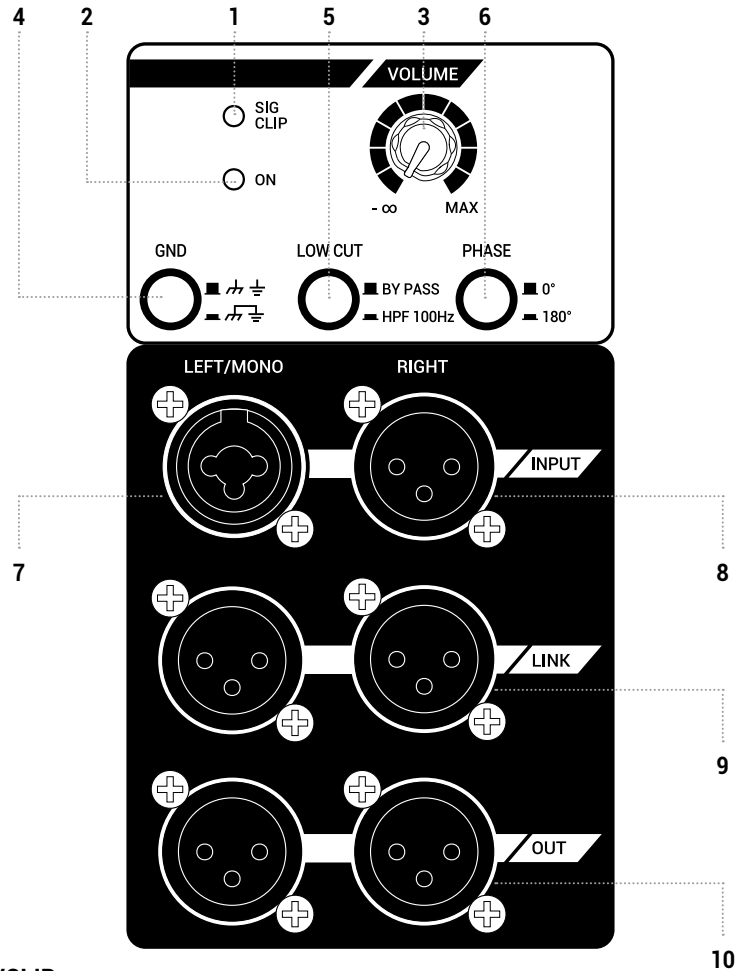

- 1 SIG/CLIP**  
 Led lit green: input signal present.  
 Led lit red: Indicates the activation of the internal limiter circuit preventing amplifier distortion and protecting the speakers against overloads. In this case, reduce the MASTER level and that of the sound source.

- 2 ON**  
 This LED is lit when the unit is plugged to mains, and the power switch is ON.
- 3 VOLUME**  
 Subwoofer master control. Turn the knob clockwise to increase volume, or counterclockwise to decrease it.
- 4 GND**  
 Press this switch to reduce or eliminate the noise of the electric ground when connecting signal lines between multiple devices. It is very effective in eliminating ground loops, but the actual result depends also on other connected devices.
- 5 LOW CUT**  
 This switch allows you to activate or deactivate the high-pass filter at 100Hz. When it is activated, use the OUT L/R to connect two additional active speakers.
- 6 PHASE**  
 Press this button to invert by 180 degrees the subwoofer phase to easily compensate possible phase cancellations due to venue acoustics, the presence of multiple subwoofers, or when using not-standard phased satellites.
- 7 LEFT/MONO INPUT**  
 Balanced combo - XLR/6.35 mm. jack - line input. You may also use an unbalanced cable.
- 8 RIGHT INPUT**  
 Balanced XLR-F line level input. You may also use an unbalanced cable.
- 9 LINK L/R**  
 Balanced Left/Right channels XLR-M line outputs for parallel wiring of further active speakers.
- 10 OUT L/R**  
 Balanced Left/Right channels XLR-M line outputs.  
 Use these outputs to connect further active speakers, whose signal is influenced by the LOW CUT filter at 100Hz.

## 3.3 | POWER SUPPLY SECTION

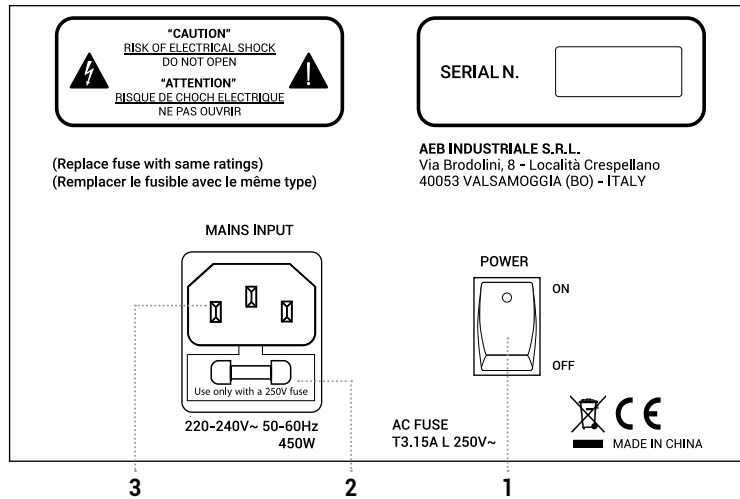

### 1 POWER ON/OFF

Use this switch to turn On/Off the unit.

### 2 FUSE

Protection fuse.



**Caution:** Replace the fuse only with one of the same type and with the same value. If the fuse blows repeatedly, contact an authorized service center.

### 3 MAINS INPUT

Insert in this socket the provided mains cable. Please, be sure the device is switched off before connecting the cable to the mains. For your safety, never disconnect the earth lead.

#### WARNING!



Never remove the product's front protection mesh. In order to prevent electric shock hazard, in the event of accidental damage or replacement of the protection mesh (which must be carried out by a service center), disconnect the power supply immediately.



**CAUTION:** To reduce the risk of electric shock, do not connect the appliance to the power supply while the mesh is removed.

## 4 | TROUBLESHOOTING

PROBLEM	LEDS	SOLUTION
No sound or very low sound level	Power LED turned off	Make sure the device is properly connected to the mains outlet
Power LED turned on, but low MASTER VOL.		Raise MASTER VOL level
Power LED turned on, MASTER VOL raised, but input channel LEVEL low.		Check the connections between sound sources and inputs. Raise channels LEVEL.
Distortion	Clip LED on	Lower the level of MIC and LINE inputs and/or MASTER level. Make sure that you haven't connected a line signal in MIC IN input
Confused sound		Make sure you haven't simultaneously activated more sound sources

## 5 | TECHNICAL SPECIFICATIONS

	<b>GREENHEAD 10</b>	<b>GREENHEAD 12</b>	<b>GREENHEAD 15</b>
System type	2-way vented box	2-way vented box	2-way vented box
LF	Ferrite custom 10" speaker - 2" V.C	Ferrite custom 12" speaker - 2" V.C	Ferrite custom 15" speaker - 2" V.C
HF	1" Compression driver	1" Compression driver	1" Compression driver
Coverage O x V	50° H x 50° V	50° H x 50° V	50° H x 50° V
Peak Power (LF+HF)	1000 W	1200 W	1200 W
Amplifier	Class D	Class D	Class D
Frequency response	58Hz - 20kHz (-10 dB)	50Hz - 20kHz (-10 dB)	50Hz - 20kHz (-10 dB)
SPL - MAX	122 dB	123 dB	125 dB
I/O Connectors	MIC: Combo XLR-F + 6,35mm (1/4") jack LINE IN: XLR F + 6,35mm jack (1/4") AUX IN: 2 x RCA jack, 3,5mm mini-jack LINE OUT: XLR-M	MIC: Combo XLR-F + 6,35mm (1/4") jack LINE IN: XLR F + 6,35mm jack (1/4") AUX IN: 2 x RCA jack, 3,5mm mini-jack LINE OUT: XLR-M	MIC: Combo XLR-F + 6,35mm (1/4") jack LINE IN: XLR F + 6,35mm jack (1/4") AUX IN: 2 x RCA jack, 3,5mm mini-jack LINE OUT: XLR-M
Controls	MIC LEVEL, LINE/AUX LEVEL, MASTER VOLUME, GND switches	MIC LEVEL, LINE/AUX LEVEL, MASTER VOLUME, GND switches	MIC LEVEL, LINE/AUX LEVEL, MASTER VOLUME, GND switches
Power Supply	220-240V~ 50-60Hz	220-240V~ 50-60Hz	220-240V~ 50-60Hz
Fuse	T3.15A L 250 V~	T3.15A L 250 V~	T3.15A L 250 V~
Cabinet material	15 mm MDF	15 mm MDF	15 mm MDF
Dimensions (WxHxD)	316 x 540 x 295 mm 12.4" x 51.3" x 11.6"	360 x 574 x 331 mm 14.2" x 22.6" x 13"	423 x 655 x 390 mm 16.7" x 25.8" x 15.4"
Weight	13.8 Kg (30.4 lbs.)	16 Kg (35.3 lbs.)	19.1 Kg (42.1 lbs.)

	<b>GREENHEAD 15S</b>	<b>GREENHEAD 18S</b>
System type	Vented box	Vented box
Driver	15" Custom Ferrite - 2.5" V.C	18" Custom Ferrite - 2.5" V.C
Peak Power (LF+HF)	1200 W	1600 W
Amplifier	Class D	Class D
Frequency response	42Hz - 120Hz (-10dB)	42Hz - 130Hz (-10dB)
SPL - MAX	126 dB	129 dB
I/O Connectors	LINE IN LEFT/MONO: XLR-F + 6,35mm (1/4") jack LINE IN RIGHT: XLR-F LINK OUT L/R: 2 x XLR-M LINE OUT: 2 x XLR-M	LINE IN LEFT/MONO: XLR-F + 6,35mm (1/4") jack LINE IN RIGHT: XLR-F LINK OUT L/R: 2 x XLR-M LINE OUT: 2 x XLR-M
Controls	VOLUME knob GND LIFT, LOW CUT, PHASE switches	VOLUME knob GND LIFT, LOW CUT, PHASE switches
Power Supply	220-240 V~ 50-60Hz	220-240 V~ 50-60Hz
Fuse	T3.15 A L 250 V~	T3.15 A L 250 V~
Cabinet material	18 mm Plywood	18 mm Plywood
Dimensions (WxHxD)	580 x 455 x 511 mm 22.8" x 17.9" x 20"	661 x 535 x 560 mm 26" x 21" x 22"
Weight	25.3 kg (55.1 lbs.)	33.2 kg (73.2 lbs.)

### EMI CLASSIFICATION

According to the standard EN55103 this equipment is designed and suitable to operate in E3 (or lower E2, E1) electromagnetic environments.



6 | NOTES | NOTE | NOTIZEN

Ruled area for notes on page 32, consisting of 20 horizontal dotted lines.

6 | NOTES | NOTE | NOTIZEN

Ruled area for notes on page 33, consisting of 20 horizontal dotted lines.

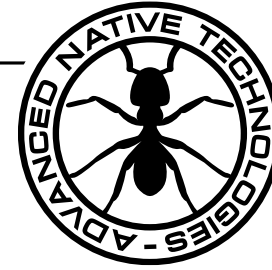

[www.ant-sound.com](http://www.ant-sound.com)

**ENG** The information contained in this manual have been carefully drawn up and checked. However no responsibility will be assumed for any incorrectness. This manual cannot cover all the possible contingencies which may arise during the product installation and use. Should further information be desired, please contact us or our local distributor. A.E.B. Industriale Srl can not be considered responsible for damages which may be caused to people and things when using this product. Specifications and features are subject to change without prior notice.

**ITA** Le informazioni contenute in questo manuale sono state attentamente redatte e controllate. Tuttavia non si assume alcuna responsabilità per eventuali inesattezze. Questo manuale non può contenere una risposta a tutti i singoli problemi che possono presentarsi durante l'installazione e l'uso dell'apparecchio. Siamo a vostra disposizione per fornirvi eventuali ulteriori informazioni e consigli. A.E.B. Industriale Srl non può essere ritenuta responsabile per danni o incidenti a cose o persone, causati o connessi all'utilizzazione o malfunzionamento dell'apparecchio.

**DEU** Die Informationen in diesem Handbuch wurden sorgfältig erstellt und überprüft. Es wird jedoch keine Haftung für Unrichtigkeiten übernommen. Dieses Handbuch kann nicht alle möglichen Eventualitäten, die während der Produktinstallation und -nutzung auftreten können, abdecken. Sollten weitere Informationen gewünscht sein, kontaktieren sie uns oder ihren lokalen Händler. A.E.B. Industriale Srl kann nicht für Schäden verantwortlich gemacht werden, die beim Benutzen dieses Produktes verursacht werden können. Technische Daten und Eigenschaften können ohne vorherige Ankündigung geändert werden.

Made in China  
Prodotto in Cina  
Produziert in China





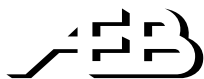

**A.E.B. Industriale Srl** - Via Brodolini, 8 - Località Crespellano  
40053 Valsamoggia - Bologna (ITALIA)  
Tel +39 051 969870 - Fax +39 051 969725